

Quick Start Guide: Gateway

Inside the box:

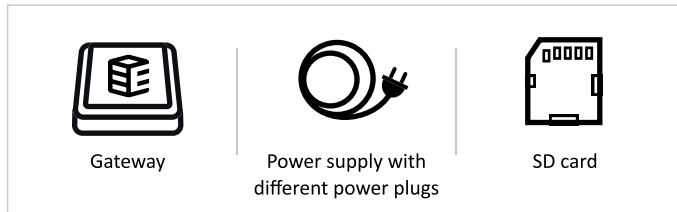

3 Make bootable SD card

An SD card with the latest firmware is necessary for the Gateway's first boot.

Prepare a few things:

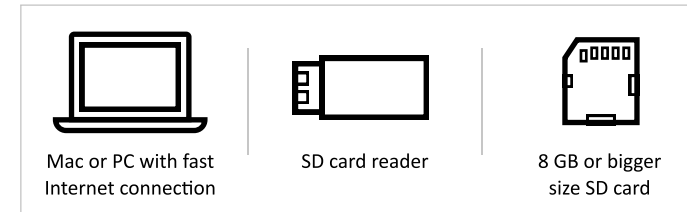

6 Install Gateway and connect to a power source

Connect Gateway to a power source AC 110-220 V with FSP AC power adapter. The Enapter Gateway can be mounted on DIN rail acc. IEC 60715 using two Wago Mounting Foot (Wago P/N: 209-123).

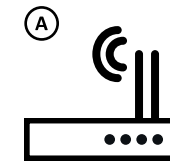

Wi-Fi connection

Gateway should be closer than **80 metres** to Wi-Fi source.

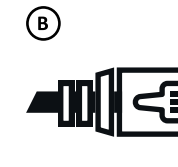

Wired connection

In case your devices are connected via a Ethernet network.

9 Protect Gateway with PIN code

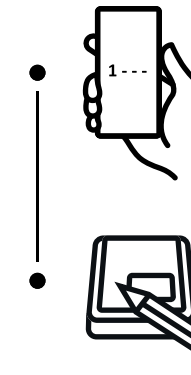

Enapter app will ask you to set up a PIN code. After successful connection encrypted connection with Gateway will be established.



Write it down on the sticker of the Enapter Gateway. In case you lose a PIN code factory reset will be needed.

1 Sign up to the Enapter Energy Management System using the mobile app

Android and iOS apps: app.enapter.com or scan QR-codes.

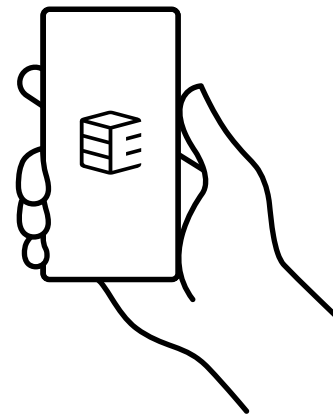

4 Write firmware to SD card using Balena Etcher

- Download Gateway firmware to computer: <https://fw.enapter.com/>
- Download and install balenaEtcher application: <https://www.balena.io/etcher/>
- Start balenaEtcher app. Click Select Image and choose firmware file. Click Select Drive and choose SD card as a target device. Plugging in the SD card automatically selects it.
- Click the **Flash!** button and wait until boot SD card is ready.

The latest documentation is always available at Enapter Handbook site. <https://handbook.enapter.com/gateway/gateway.html>

7 First boot

- Ensure Gateway is powered on. In case automatic boot is not enabled, press **Power** button.
- Wait approximately 2 minutes for the Gateway to boot.

10 Monitor device activity in Enapter app

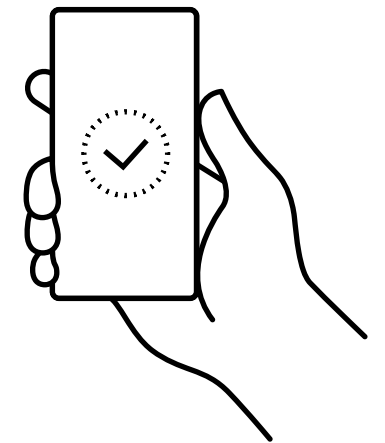

2 Create your site using the mobile app

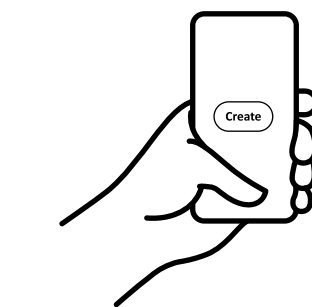

Site is a group for your devices such as Enapter electrolyzers or 3rd party devices integrated with Enapter UCMs.

5 Insert SD card to Enapter Gateway

As soon as the power cable is plugged in, the Gateway starts to boot automatically. Please ensure you plug the bootable SD card first.



8 Scan QR-code with Enapter app to add Gateway to your site

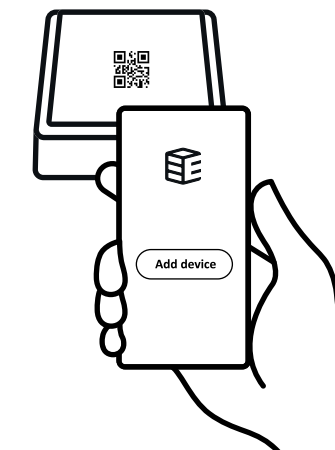

- Open your site in the Enapter app and press **Add Device**.
- Scan QR-code located on top of the Gateway. If you can't scan, enter Device ID and PIN manually. They are located on top of the lid of the Gateway.
- Follow Enapter app instructions.



It is recommended that you finish the Gateway setup before adding more devices.



More info about Enapter devices on handbook.enapter.com.

For support write to support@enapter.com



Alternating current voltage of 110-220 V is potentially lethal! All works on assembly and installation should be performed only with a disconnected power supply!



All product names and trademarks are property of their respective owners.